

INSTRUCTION MANUAL

RDR1520

DIGITAL TWO-WAY RADIOS

Models Covered: RDR1520U (UHF) / RDR1520V (VHF)

RCA
Communications Systems

prodigi[™]
PROFESSIONAL DIGITAL RADIO PRODUCTS

Congratulations and Thank You for selecting the PRODIGI RDR1520 Series portable two-way radio from RCA Communications Systems
- *The most trusted name in radio!*

Our newest digital series professional communications products based on DMR technology establishes a benchmark in premium digital two-way radio equipment, made to perform flawlessly under the most demanding commercial conditions. Cutting edge design, high-end professional grade materials and components, simple operation and superior assembly quality: RCA Communications Systems has it all, including our exclusive no-nonsense, four-year “Warranty Protection Program,” one of the most comprehensive warranties in the communications industry.

To ensure you achieve maximum performance from your RDR1520 radio, please be sure to carefully read this manual.

MODELS COVERED IN THIS MANUAL:

- RDR1520™ VHF Two-Way Radio
- RDR1520™ UHF Two-Way Radio



CONTENTS:

Safety and General Information	4
Product Inspection	5
RCARDR1520™ Series Overview	6

Preparing Radio For Initial Use

Setting Up the Charger.....	7
Charging the Battery.....	7
Battery Storage.....	9
Attaching / Removing Battery.....	9
Attaching / Removing Antenna.....	9
Attaching / Removing Belt Clip.....	11
Connecting Audio Accessories.....	11
Turn Radio On / Off.....	12
Adjusting the Volume.....	12

Programmable Buttons	13
Assignable Radio Functions.....	13-14

Switch Between Analog / Digital Mode	14
---	----

Transmission	15
Analog transmission.....	15
Digital transmission.....	15

Making and Receiving Calls

Selecting a Zone.....	15
Selecting a Channel.....	15
Receiving & Responding to a Group Call.....	15
Receiving & Responding to a Private Call.....	16
Receiving an All Call.....	16
Making Radio Calls (Group/Private/All Call).....	16
Making a Group or Private Call One Touch Access Button.....	17

Advanced Features

Emergency Operation.....	17
Initiating/Responding to Emergency Alarm.....	18
Exiting Emergency Mode.....	18
Channel Scan.....	19
Scan Instructions and Methods.....	19
Starting and Stopping Scan.....	20
Responding to a Scan.....	20
Deleting a Nuisance Channel.....	20
Restoring a Nuisance Channel.....	21
Dual Tone Multi Frequency (DTMF).....	21

CONTENTS *continued*

Utilities

Setting the Squelch Level.....21

Setting the Power Level.....21

Care and Cleaning.....22

Troubleshooting.....23

FCC Statement.....24

Industry Canada Compliance.....25

**RF Exposure Compliance & Control Guidelines
& Operating Instructions**.....26

**EXPOSURE RF compliance et Lignes de contrôle
et Instructions opérationnelles**.....27

Warranty Statement.....29

Customer Support Contact Info.....31

SAFETY AND GENERAL INFORMATION

This radio is restricted to occupational use only to satisfy FCC RF energy exposure requirements. Before using this product, read the operating instructions.

- » Turn radio off prior to entering any area with a potentially explosive atmosphere, such as gas, petroleum, chemicals, blasting caps, etc.
- » Do not charge the battery in a potentially explosive atmosphere.
- » Do not use any portable radio that has a damaged antenna, as it can burn your skin.
- » This equipment is to be serviced only by authorized RCA Communications Systems technicians. Any service performed by unauthorized technicians will void the warranty.
- » Turn radio off when near electrical blasting caps to avoid possible interference with blasting operations. Obey posted signs

such as those in hospitals or blasting areas advising people to turn off all two-way radios. Obey pilots and flight attendants instructions to turn off radios on airplanes.

- » Do not place a radio over an air bag or in an air bag's deployment area, as the force with which an air bag is inflated could propel the radio and may cause serious injury.
- » Do not place the radio close to a heat source or expose the radio to direct sunlight for a prolonged period of time.
- » Hold the radio while in use in a vertical position with the microphone one to two inches away from your lips.
- » While wearing a transmitting radio, keep the radio and its antenna at least one inch away from your body.

For a complete list of RCA approved antennas, batteries, chargers, holsters and audio accessories, visit:

<http://www.rcacommunicationssystem.com>

PRODUCT INSPECTION

Prior to unpacking your RDR1520 Series portable radio, please inspect the packaging for signs of damage and report any damage or missing components immediately to your RCA Communications Systems Sales and Service Outlet. Every RDR1520 Series portable radio comes with the following items:

Item	Qty.
RDR1520™ -Handheld Radio	1
B1520LI - Li-Ion Battery (2000 mAh)	1
ANH1520U - Antenna for UHF Models ANH1520V - Antenna for VHF Models	1
BC1520 - Belt Clip	1
Instruction Manual	1
CH1521* - Desktop Rapid Charger	1
PS1521* - Power Supply	1



RDR1520™
Handheld Radio



B1520LI
Li-Ion Battery
(2000 mAh)



Antenna
ANH1520U - UHF models
ANH1520V - VHF models



BC1520
Belt Clip



PS1521*
Power Supply



CH1521*
Desktop Rapid Charger

*Items sent in separate box if ordered.

RCA RDR1520™ Series Overview

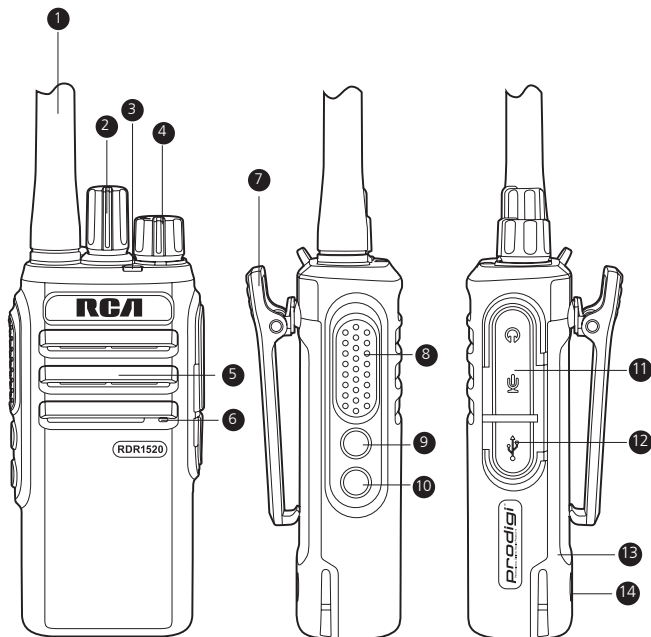

- 1 Antenna
- 2 Channel Knob
- 3 LED Indicator
- 4 On/Off/Volume Knob
- 5 Speaker
- 6 Microphone
- 7 Screw-On Belt Clip
- 8 Push-to-Talk (PTT) Button
- 9 Side Button 1 *
- 10 Side Button 2 *
- 11 Accessories Connector
- 12 Micro-USB (for charging & programming)
- 13 Battery
- 14 Battery Charging Contact Points

* These buttons are programmable by your RCA Communications Systems Dealer only upon request at the time of purchase.

Preparing Your Radio for Initial Use

Setting Up Your Charger

1. Plug the adapter's AC connector into the AC outlet socket. (see image A)
2. Plug the adapter's DC connector into the DC socket on the back of the charger. (see image B)
3. Place the radio with the battery attached, or the battery alone, in the charger. (see image C)
4. Make sure the battery contact is touching the charging terminals. The charging process begins when the red LED light illuminates.
5. The green LED light will illuminate approximately two hours later, indicating the battery is fully charged.

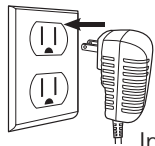

Image A



Image B

Battery Information

Charging the Battery

Your radio is powered by a Lithium-Ion (Li-Ion) battery. To avoid damage and comply with warranty terms, charge the battery using only an original RCA charger, exactly as described in the charger user guide. When the charger's LED illuminates red, it is an indication that the battery is being correctly charged. When the LED illuminates green, the battery charge is complete.

Note: Charge a new battery 12 to 14 hours before initial use for best performance. Maximum battery capacity is normally achieved after two or three full charge / discharge cycles.

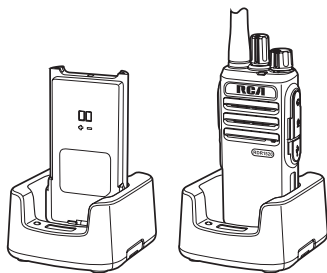

Image C

Caution:

To reduce the risk of injury, use only batteries specified by RCA Communications Systems.

- To avoid risk of personal injury, do not dispose of batteries in a fire.
- Dispose of batteries according to local recycling regulations. Do not dispose as household waste.
- Never attempt to disassemble the battery.
- When charging a battery, keep it at a temperature between 41°F ~ 104°F (5°C ~ 40°C) to ensure a full charge. Temperatures outside this range significantly reduce

battery life. If the operating time (talk-time and standby time) is noticeably shorter than normal, replace the battery.

- Before charging a battery attached to a radio, turn the radio off to ensure a full charge. Never leave a radio on while in the charger, as it can damage both the battery and the radio; the charger is not a radio stand.
- Do not cut off the power supply or remove battery while charging.
- Never charge a battery that is wet. Dry it with soft cloth prior charging.
- The battery will eventually weaken. When the operating time (talk-time and standby time) becomes noticeably shorter than normal, replace the battery.
- Battery performance greatly decreases at temperatures below -4°F (-20°C). Having a spare battery is always necessary in extremely cold environments. A cold

battery may work again when it returns to room temperature, so keep it for later use.

- Dust on the battery contact may cause the battery not to work or charge properly. Use a clean dry cloth to wipe it before attaching the battery to the radio.
- Batteries with damaged contacts can be extremely dangerous. Any battery with damage to one or more contacts should be replaced immediately and not used under any circumstances.

Battery Storage

1. Fully charge a battery before storing it for an extended period of time to avoid battery damage due to over-discharge.
2. Recharge a battery after three months storage to avoid reduced battery capacity due to over-discharge.
3. When storing a battery, keep it in a dry place at room temperature.

Attaching & Removing the Battery

1. Attach the battery on the back of the radio by aligning the side rails and pushing battery up as shown until it clicks into place. (See Figure 1)
2. Remove the battery by pressing the battery release button and sliding the battery down as shown. (See Figure 2)

Note: If the battery is not securely locked, remove it and reattach it.

Figure 1

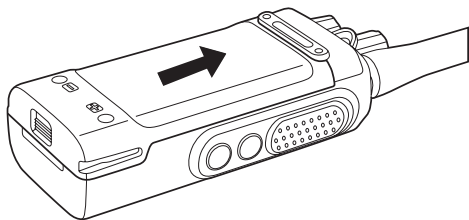
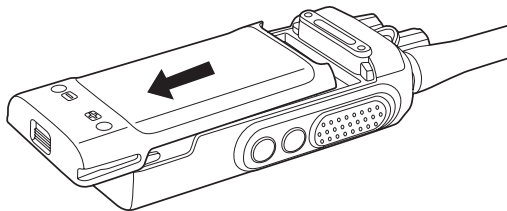
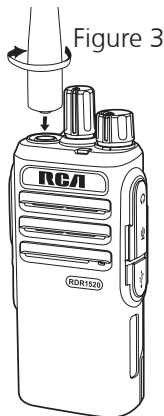

Figure 2



Attaching / Removing the Antenna

1. With the radio turned off, set the antenna in its receptacle and turn clockwise until it is screwed down. (See Figure 3)
2. To remove the antenna, turn the radio off and turn the antenna counterclockwise. (See Figure 4)



* If antenna needs to be replaced, ensure that only RCA Communications Systems antennas are used. Damaged Antennas may reduce your radio coverage.

Attaching / Removing the Belt Clip

Using a small screwdriver, align the belt clip's screw holes to the radio's chassis. Attach by turning the screws clockwise into the belt clip's screw holes. Remove by doing the reverse.

(See Figure 5)

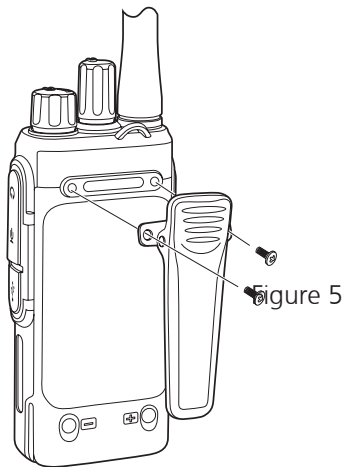

Connecting Audio Accessories

The accessory connector is located on the side of the radio. It is used to connect RCA audio accessories to the radio. Remove the accessory cover by unscrewing the screw location at the bottom of the cover. Connect the desired audio accessory firmly into the accessory jack and secure the screw by turning it clockwise. (See Figure 6)

Note: Please loosen the screw prior to removing the audio accessory.

The use of the audio accessory may affect the waterproof performance of the radio.

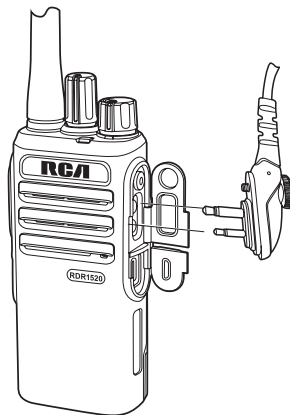

Figure 6

Turn On/Off the Radio

1. Rotate the On/Off/Volume Control Knob clockwise until you hear a click. (See Figure 7) The LED blinks green and a brief tone sounds, indicating that the power up test is successful.
2. To turn off the radio, rotate this knob counterclockwise until you hear a click.

Note: There is no power up tone if the radio tones/alerts function is disabled. If your radio does not power up, check your battery. Make sure that it is charged and properly attached. If your radio still does not power up, contact your RCA Communications Systems dealer.

Adjusting the Volume

To increase the volume, turn the On/Off/Volume Control Knob clockwise. To decrease the volume, turn this knob counterclockwise. (See Figure 7)

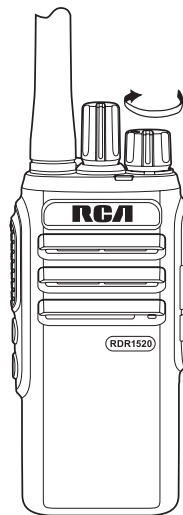

Figure 7

Programmable Buttons

Your RCA Communications Systems Dealer can program the programmable buttons as shortcuts to radio functions or preset channels/groups depending on the duration of a button press:

- Short Press - Press and release quickly.
- Long press - Press and hold for the programmed duration (between 1 seconds and 3.75 seconds).

The Programmable Functions are:	
Unassigned	All Alert Tones On/Off
Emergency On	Emergency Off
High/Low Transmit Power	Monitor On/Off
Nuisance Channels Delete	One Touch Access 1
One Touch Access 2	One Touch Access 3
One Touch Access 4	One Touch Access 5
One Touch Access 6	Repeater/Talkaround
Scan On/Off	Tight/Normal Squelch
Privacy On/Off	VOX On/Off
Battery Indicator	Lone Worker On/Off
Tone Select	

All Alert Tones On/Off - Toggles all tones and alerts on or off.

Emergency On - Initiates an emergency alarm or call.

Emergency Off - Cancels an emergency alarm or call.

High/Low Transmit Power - Toggles transmit power level between high and low.

Monitor On/Off - Monitors a selected channel for activity.

Nuisance Channels Delete - Temporarily removes an unwanted channel, except for the Selected Channel, from the scan list. The Selected Channel refers to the user's selected zone/channel combination from which scan is initiated.

One Touch Access - Directly initiates a predefined Private or Group Call, a Call Alert or a Quick Text message.

Repeater/Talkaround - Allows the user to toggle between Repeater and Talkaround mode.

Scan On/Off - Toggles scan on or off.

Tight/Normal Squelch - Toggles squelch level between tight and normal squelch levels.
Privacy On/Off - Toggles privacy (basic voice encryption) on or off.

Privacy On/Off - Allows the user to toggle the Privacy feature between on and off for the channel.

VOX On/Off - Toggles Voice Activated Function on or off.

Battery Indicator - Indicates battery charge level, low, medium or high.

Lone Worker On/Off - Toggles Lone Worker feature On or Off, on per channel basis.

Push-To-Talk (PTT) Button

The PTT button on the side of the radio has two main functions:

- Press and hold down PTT button to initiate and call and talk. Release the PTT button to listen. The microphone is activated when the PTT button is pressed.

- If a call is in progress, the PTT button allows the radio to transmit to the other radios that are part of the call.

Note: If the Talk Permit Tone is enabled, wait until the short alert tone ends before talking.

During a call, if the Channel Free Indication feature is enabled on your radio (programmed by your RCA Communications Systems Dealer), you will hear a short alert tone the moment the target radio (the radio that is receiving your call) releases the PTT button, indicating the channel is free for you to respond. You will also hear the Channel Free Indication tone if your call is interrupted, for example when the radio receives an Emergency Call.

Switching Between Analog and Digital Mode

Each channel in your radio can be programmed as an analog channel or a digital channel. Use the Channel Selector Knob to switch between an analog or a digital channel.

Note: When switching from digital to analog mode, certain features of the radio become unavailable.

Transmission

Analog transmission:

Press PTT key and speak into the mic.

Digital transmission:

Each channel can be set as a digital channel:

Press PTT key to call all other members in this talk group, and release PTT to receive calls. When the call is completed, press PTT again to initiate a new call (use the channel knob to select one channel or recall one with ONE TOUCH ACCESS). If the Talk Permit Tone was programmed, the radio will sound a tone, to indicate that you can talk.

Making and Receiving Calls

Selecting a Zone

Zones are groups of channels. RDR1520 offers up to 2 zones with a maximum of 16 channels per zone. You can change zones with radio's function keys as programmed by your RCA Communications Systems dealer.

Selecting a Channel

Once the required zone is displayed (if you have multiple zones in your radio), turn the programmed Channel Selector Knob to select the desired channel.

Receiving and Responding to a Group Call

To receive a call from a group of users, your radio must be configured as part of that group and assigned to the channel you are currently on. When you receive a Group Call the LED blinks green.

Once the transmission is completed, press* and hold the [PTT] button to respond to the call and the LED indicator lights up red. When done, release the [PTT] button to listen again. If there is no voice activity for a set period of time, the call ends.

***Note:** If Talk Permit Function is enabled, wait for the Talk Permit Tone to finish and then speak clearly into the microphone.

Receiving and Responding to a Private Call

A Private Call is a call from an individual radio to another individual radio. When you receive a Group Call the LED blinks green.

Once the transmission is completed, press* and hold the [PTT] button to respond to the call and the LED indicator lights up red. When done, release the [PTT] button to listen again. If there is no voice activity for a set period of time, the call ends.

***Note:** If Talk Permit Function is enabled, wait for the Talk Permit Tone to finish and then speak clearly into the microphone.

Receiving an All Call

An All Call is a call from an individual radio to every radio on the channel. It is used to make important announcements requiring all radio user's full attention. When you receive an All Call the LED blinks green.

***Note:** The radio stops receiving the All Call if you switch to a different channel while receiving the call.

Making a Radio Call (Group, Private or All Call)

Select the desired channel by using the channel Selector Knob. To make a call to a Group, Private or All Call, your radio must be configured with the respective Group, Private or All Call contact on the channel you are on. Press* and hold the

[PTT] button to make the call. When done release the [PTT] button to listen.

***Note:** If Talk Permit Function is enabled, wait for the Talk Permit Tone to finish and then speak clearly into the microphone.

Making a Group or Private Call One Touch Access Button

The One Touch Access feature allows you to make a Group or Private Call to a predefined alias or ID easily. This feature can be assigned to a short or long programmable button press. You can only have one alias or ID assigned to a One Touch Access button. Your radio can have multiple One Touch Access buttons programmed.

Press the programmed One Touch Access button to make a Group or Private Call to the predefined alias or ID. Press* and hold the [PTT] button to make the call.

When done release the [PTT] button to listen.

***Note:** If Talk Permit Function is enabled, wait for the Talk Permit Tone to finish and then speak clearly into the microphone.

Advanced Features

Emergency Operation

Note: This function is available in Digital Mode Only!

An Emergency Alarm is used to indicate a critical situation.

Your radio supports 3 Emergency Alarms:

- Emergency Alarm
- Emergency Alarm with Call
- Emergency Alarm with Voice to Follow

Each alarm has the following default setting:

Disabled: Radio cannot transmit alarm signal, but can receive alarm from other radios. Each alarm has the following types:

Regular: Radio transmits an alarm signal and shows audio and/or visual indicators.

Silent: Radio transmits an alarm signal without any audio or visual indicators. There will be no response (call) from the target radio until you press the PTT button to initiate the call.

Silent with Voice: Radio transmits an alarm signal and is able to receive an incoming call, without any audio or visual indicators, until you press the [PTT] button to initiate, or respond to the call.

Initiating & Responding to Emergency Alarm

To initiate an Emergency Alarm press the programmed Emergency button. The LED lights up solid red. After the alarm is sent successfully depending on the setting selected you can press the [PTT] to talk or your radio's microphone is automatically activated, allowing you to communicate with the other radio without pressing the [PTT] button.

To Respond to an Emergency Alarm Press any button to stop all Emergency Alarm received indications. Press [PTT] button to initiate a call with the emergency initiating radio.

Exiting Emergency Mode

Your radio exits Emergency mode automatically when any of the following occurs:

- Emergency Alarm acknowledgement is received (for Emergency Alarm only), OR
- All retries to send the alarm have been exhausted, OR
- The Emergency Off button is pressed, OR
- The [PTT] button is pressed

Note: If your radio is powered off, it exits the Emergency mode. The radio will not re-initiate the Emergency mode automatically when it is turned on again.

Channel Scan

Scan lists are created and assigned to individual channels / groups. The radio scans for voice activity by cycling through the channel/group sequence specified in the scan list for the current channel / group. Your radio can support up to 250 scan lists, with a maximum of 16 members in a list. Each scan list supports a mixture

of both analog and digital entries. You can add, delete, or prioritize channels by editing the scan lists.

Scan Instructions and Methods

When a scan is initiated, your radio cycles through the programmed scan list for the current channel looking for voice activity. The LED blinks red.

There are two ways of initiating scan:

- **Manual Scan:** Initiate scan manually using the programmed by your RCA Communications Systems dealer Scan ON/OFF side button. When scan is initiated, radio will detect all channels / groups on the programmed scan list.
- **Auto Scan:** Your radio automatically starts scanning when you select a channel / group that has Auto Scan enabled

Starting and Stopping Scan

Press the programmed Scan On/Off side programmable button to start the scanning. Press it again to turn it off.

Responding to a Scan

During scanning, your radio stops on any channel / group where activity is detected. After the transmission is over the radio remains on the active channel for a programmed time period known as “hang time”.

- Press the PTT button during hang time to respond to the call. The LED lights up red.
- Release PTT button to listen.

Note: If you do not respond within the hang time period, the radio continues scanning other channels / groups.

Deleting a Nuisance Channel

If a channel continually generates unwanted calls or noise (termed a “nuisance” channel), you can temporarily remove the unwanted channel from the scan list.

Note: This capability does not apply to the channel designated as the Selected Channel.

This feature is not accessible through the menu.

- When your radio stops on an unwanted or nuisance channel, press the programmed Nuisance Channel Delete button until you hear a tone.
- Release the Nuisance Channel Delete button. The nuisance channel is deleted.

Restoring a Nuisance Channel

To restore the deleted nuisance channel, power the radio off and back on again or press Stop and Start to restart a scan via the programmed Scan button.

Dual Tone Multi Frequency (DTMF)

The Dual Tone Multi Frequency (DTMF) feature allows the radio to operate in a radio system with an interface to telephone or other DTMF based systems. DTMF Codes can be programmed into the radio by your RCA Communications Systems dealer. DTMF receive/transmit feature has four optional modes with 32 encode groups with up to 30 characters per group. To use this feature, your radio must have an access code, which is system dependent. Please contact your RCA Communications Systems dealer or system administrator for more information.

Utilities

Setting the Squelch Level

You can adjust your radio's squelch level to filter out unwanted calls with low signal strength or channels that have a higher than normal background noise.

Settings: Normal is the default level. Tight may help to filter out (unwanted) calls and / or background noise. However, calls from radio within your system that are in very remote locations may also be filtered out. Press the programmed Squelch button to toggle squelch level between normal and tight.

Setting the Power Level

You can customize your radio's power setting to high, mid-high, mid-low, and low for digital channels, or mid-high, mid-low, low for analog channels.

Settings: High enables communication with radios located at a considerable distance from you. Low enables communication with radios in closer proximity. Press the programmed Power Level button to toggle transmits power level between high and low.

CARE AND CLEANING

- Do not hold the radio by its antenna or external microphone.
- Do not place the radio in a dusty environment.
- Clean with a lint-free cloth moistened with clean water or a mild dishwashing liquid.
- Avoid exposing to corrosives, solvents or spirits.

TROUBLESHOOTING

Symptom	Solution
Radio will not power on	<ul style="list-style-type: none">a. The battery needs charging. Recharge the battery or replace it with a fresh one.b. The battery is not properly installed. Remove the battery and reattach it.
The operating time is noticeably shorter than normal even though the battery is properly charged.	<ul style="list-style-type: none">a. The battery has worn out; it is time to buy a new battery.b. The battery is not fully charged. Make sure that the battery is removed after LED indicator has turned green.
Cannot talk to or hear transmissions from your group members	<ul style="list-style-type: none">a. Make sure that your radio operates on the same channel and / or has the same CTCSS/CDCSS settings and/or it is a part of the same talk group.b. Make sure you are within their communication range.
Radio is on, but you cannot hear voice transmissions or they are not very loud	<ul style="list-style-type: none">a. Turn the volume control knob to its maximum volume.b. Return the radio to your dealer to check for microphone damage.

FCC Statement:

This device complies with Part 15 of the FCC Rules. Operation is subject to the following two conditions:

- (1) This device may not cause harmful interference, and
- (2) this device must accept any interference received, including interference that may cause undesired operation.

NOTE 1: This equipment has been tested and found to comply with the limits for a Class B digital device, pursuant to part 15 of the FCC Rules. These limits are designed to provide reasonable protection against harmful interference in a residential installation.

This equipment generates, uses and can radiate radio frequency energy and, if not installed and used in accordance with the instructions, may cause harmful interference to radio communications. However, there is no guarantee that interference will not occur

in a particular installation. If this equipment does cause harmful interference to radio or television reception, which can be determined by turning the equipment off and on, the user is encouraged to try to correct the interference by one or more of the following measures:

- Reorient or relocate the receiving antenna.
- Increase the separation between the equipment and receiver.
- Connect the equipment into an outlet on a circuit different from that to which the receiver is connected.
- Consult the dealer or an experienced radio/TV technician for help.

NOTE 2: Any changes or modifications to this unit not expressly approved by the party responsible for compliance could void the user's authority to operate the equipment.

Industry Canada Compliance

This device complies with Industry Canada's license-exempt RSSs. Operation is subject to the following two conditions: (1) This device may not cause interference; and (2) This device must accept any interference, including interference that may cause undesired operation of the device. Le présent appareil est conforme aux CNR d'Industrie Canada applicables aux appareils radio exempts de licence.

L'exploitation est autorisée aux deux conditions suivantes : (1) l'appareil ne doit pas produire de brouillage, et (2) l'utilisateur de l'appareil doit accepter tout brouillage radioélectrique subi, même si le brouillage est susceptible d'en compromettre le fonctionnement.

WARNING: Under Industry Canada regulations, this radio transmitter may only operate using an antenna of a type and maximum (or lesser) gain approved for the transmitter by Industry Canada. To reduce potential radio interference to other users, the antenna type and its gain should be so

chosen that the equivalent isotropically radiated power (e.i.r.p.) is not more than that necessary for successful communication. The transmitter antenna gain shall not exceed 0 dBi.

FRENCH: Conformément à la réglementation d'Industrie Canada, le présent émetteur radio peut fonctionner avec une antenne d'un type et d'un gain maximal (ou inférieur) approuvé pour l'émetteur par Industrie Canada. Dans le but de réduire les risques de brouillage radioélectrique à l'intention des autres utilisateurs, il faut choisir le type d'antenne et son gain de sorte que la puissance isotrope rayonnée équivalente (p.i.r.e.) ne dépasse pas l'intensité nécessaire à l'établissement d'une communication satisfaisante.

Please refer to the following websites for more information on what RF energy exposure is and how to control your exposure to assure compliance with established RF exposure limits.
<http://www.ic.gc.ca/eic/site/smt-gst.nsf/eng/sf01904.html> http://www.ic.gc.ca/eic/site/ceb-bhst.nsf/eng/h_tt00080.html

RF Exposure Compliance and Control Guidelines and Operating Instructions

To control your exposure and ensure compliance with the occupational/controlled environment exposure limits always adhere to the following procedures.

Guidelines:

- Do not remove the RF Exposure Label from the device.
- User awareness instructions should accompany device when transferred to other users.
- Do not use this device if the operational requirements described herein are not met.

Operating Instructions:

- Transmit no more than the rated duty factor of 50% of the time. To transmit (talk), push the Push-To-Talk (PTT) button. To receive calls, release the PTT button. Transmitting 50% of the time, or less, is important because this radio generates measurable

RF energy exposure only when transmitting (in terms of measuring for standards compliance).

- Hold the radio in a vertical position in front of face with the microphone (and the other parts of the radio, including the antenna) at least one inch (2.5 cm) away from the nose. Keeping the radio at the proper distance is important because RF exposures decrease with distance from the antenna. Antenna should be kept away from eyes.
- When worn on the body, always place the radio in a RCA's approved clip for this product. Using approved body-worn accessories is important because the use of RCA's or other manufacturer's non-approved accessories may result in exposure levels, which exceed the occupational/controlled environment RF exposure limits.
- If you are not using a body-worn accessory and are not using the radio in the intended use position in front of the face, then

ensure the antenna and the radio are kept at least 2.5 cm (one inch) from the body when transmitting. Keeping the radio at the proper distance is important because RF exposures decrease with increasing distance from the antenna.

Use only RCA Communications Systems approved, supplied or replacement antennas, batteries, and accessories. Use of non-approved antennas, batteries, and accessories may exceed the FCC and IC RF exposure guidelines.

EXPOSURE RF compliance et Lignes de contrôle et Instructions opérationnelles

Pour contrôler votre exposition et assurer la conformité avec le milieu ambiant, il est toujours nécessaire de suivre les procédures suivies.

Taliban:

- On ne peut pas enlever le Label RF de ce dispositif.
- L'utilisateur doit utiliser le dispositif de

référence pour les autres utilisateurs.

- Il ne faut pas utiliser cet appareil pour les besoins opérationnels.

Description des opérations:

- La transmission ne dépasse pas 50% de la valeur nominale. Pour téléporter (appel), appuyez sur le bouton "Push – To– Talk" (PTT). Pour recevoir un appel, libérez le bouton du PTT. La réduction de 50 % du temps, ou moins, est importante, étant donné que cette radio a été exposée à la seule fois que la radioactivité de la radioactivité a été utilisée en tant que mesure de conformité.
- La radio est placée en face de face avec le microphone (et les autres parts de la radio) à moins d'un inch (2,5 cm). Le maintien de la radio à distance est important car il est important que les données soient tirées de la distance.
- Quand on est sur le corps, toujours place

la radio dans un clip pour ce produit.

Le recours à la procédure de recours est important parce que la use de ces produits ou autres produits non réglementés peut avoir des effets secondaires, C'est ce qui est le plus important.

- Si vous n'utilisez pas une personne pour accéder à la radio dans le front de la face, Il est donc essentiel que la chaîne et la radio soient maintenues à moins de 2,5 cm (un inch) de la personne quand il s'agit de la transmission du corps distance séparée de l'antenne.

ISED Compliance statement

This device complies with Industry Canada licence-exempt RSS standard(s).

Operation is subject to the following two conditions:

1. this device may not cause interference, and

2. this device must accept any interference, including interference that may cause undesired operation of the device.

Le présent appareil est conforme aux CNR d'Industrie Canada applicables aux appareils radio exempts de licence. L'exploitation est autorisée aux deux conditions suivantes :

1. l'appareil ne doit pas produire de brouillage, et
2. l'utilisateur de l'appareil doit accepter tout brouillage radioélectrique subi, même si le brouillage est susceptible d'en

WARRANTY STATEMENT

RCA Communications Systems warrants each new radio product it supplies to be free from defects in material and workmanship under normal use and service for the time period listed below, provided that the user has complied with the requirements stated herein.

The warranty period begins on the date of purchase from an Authorized RCA Communications Systems Sales and Service Outlet. This warranty is offered to the original end user and is not assignable or transferable. RCA Communications Systems is not responsible for any ancillary equipment which is attached to or used in conjunction with RCA Communications Systems products.

RCA Communications Systems offers to the original end user a Two (2) Year Limited Warranty on the RCA RDR1520™ Radio Handset. The RDR1520™ Antenna, RDR1520™ Battery and the RDR1520™ Battery Charger are covered under a One (1) Year Limited Warranty. The RDR1520™ Belt Clip is not covered under the warranty.

During this period, if the product fails to function under normal use because of manufacturing defect(s) or workmanship, it should be returned to the Authorized RCA Communications Systems Sales and Service Outlet from which it was purchased. The Sales and Service Outlet will repair the product to full operating specifications or replace the product with a new product of the same make and model. The user is responsible for all charges incurred in returning the product to the Authorized RCA Communications Systems Sales and Service Outlet. RCA Communications Systems will be responsible for all charges in returning the product to the end user via standard ground shipping service.

RCA Communications Systems shall have no obligation to repair or replace the product, if there is damage as a result of normal wear and tear or if the damage is caused in whole or in part by catastrophe, fault or negligence of the user, improper or unauthorized alterations or repairs to the product, incorrect wiring, use of the product in a manner for which it was not designed, or by causes external to the product. This warranty is void if the product serial number is altered, defaced or removed.

THE EXPRESS WARRANTIES CONTAINED HEREIN ARE IN LIEU OF ALL OTHER WARRANTIES, EITHER EXPRESSED OR IMPLIED OR STATUTORY, INCLUDING, WITHOUT LIMITATION, ANY WARRANTY OF MERCHANTABILITY OR FITNESS FOR A PARTICULAR PURPOSE.

FOR ANY PRODUCT WHICH DOES NOT COMPLY WITH THE WARRANTY SPECIFIED, THE SOLE REMEDY WILL BE REPAIR OR REPLACEMENT. IN NO EVENT WILL RCA COMMUNICATIONS SYSTEMS BE LIABLE TO THE BUYER OR ITS CUSTOMERS FOR ANY DAMAGES, INCLUDING ANY SPECIAL, INCIDENTAL, INDIRECT OR CONSEQUENTIAL DAMAGES, OR THE LOSS OF PROFIT, REVENUE OR DATA ARISING OUT OF THE USE OR THE INABILITY TO USE THE PRODUCT.

RCA Communications Systems endeavors to achieve the accuracy and completeness of this manual, but is not liable for any possible omission and printing mistakes.

All the above specifications and design are subject to change without prior notice.

All the reproduction and translation of this manual without authorization is prohibited.

In this manual, we strive to achieve accuracy and completeness, but provide no warranty of accuracy or reliability. All the above specifications and design are subject to change without notice due to continuous development.

No part of this manual may be copied, reproduced, translated, stored in a retrieval system, distributed, or transmitted in any form or by any means, electronic or mechanical, for any purpose without the expressed, written permission from RCA Communications Systems.

The end-user of any two-way radio is solely responsible for obtaining any license or other authorizations required by the Federal Communications Commission (FCC). For further information visit www.fcc.gov or call 1-888-CALL-FCC (1-888-225-5322).

For Sales, Warranty and Customer Support please contact:

Discount Two-Way Radio Corporation – Worldwide Distributor

555 W. Victoria Street

Rancho Dominguez, CA 90220

Phone: 310-224-5100 / Fax: 310-224-5101

www.discounttwo-wayradio.com

NOTES:

This image shows a blank sheet of white paper with horizontal ruling lines. The lines are evenly spaced and run across the width of the page. There are no margins, text, or other markings on the paper.



RCACommunicationsSystems.com

© 2019 RCA Communications Systems. All rights reserved.